

Silverflame Fire Batt will give up to 4 hours fire & smoke barrier when applied as below. However if clear opening exceeds 0.72m<sup>2</sup> then framing system will be required. Definition of clear area:

Void = 1.4m x 0.6m = Clear Area 0.78m<sup>2</sup>

Penetration System = 0.2m x 0.5m = 0.1m<sup>2</sup>

Void 0.78m<sup>2</sup> - Penetrating System 0.1m<sup>2</sup> = Clear Area 0.68m<sup>2</sup> = no framing required.

For areas requiring framing please refer to Firestopit Installation Manual

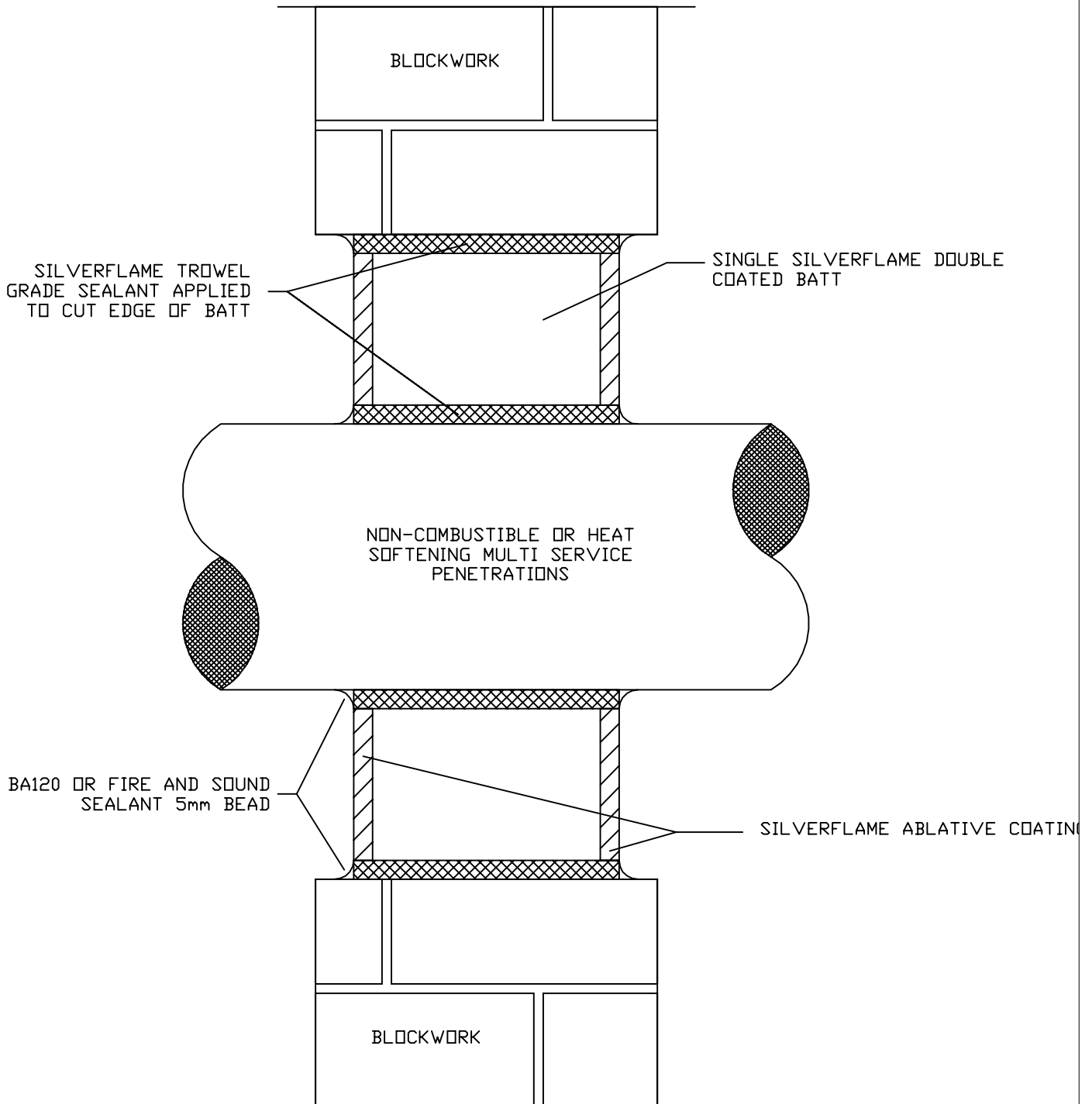

Firestopit.com  
 Swadlincote Road  
 Woodville  
 Swadlincote  
 DE11 8DD, UK.  
 TEL: 01283 229022  
 FAX: 01283 222219

FILE NAME:

DET02

DATE:

30/04/02

THESE DESIGN DETAILS REMAIN THE PROPERTY OF FIRESTOPIT.COM AND SHOULD NOT BE USED IN CONJUNCTION WITH ANY OTHER MANUFACTURERS PRODUCTS OR SPECIFICATIONS. DOING SO MAY RESULT IN THE FAILURE OF THE FIRE STOPPING SYSTEM AND WILL RENDER ANY PRODUCT OR SYSTEM GUARANTEES NULL & VOID