

FIRE STOPPING OF TYPICAL PARTITION WALL DETAIL WITH NON-COMBUSTIBLE AND NON HEAT SOFTENING PENETRATIONS

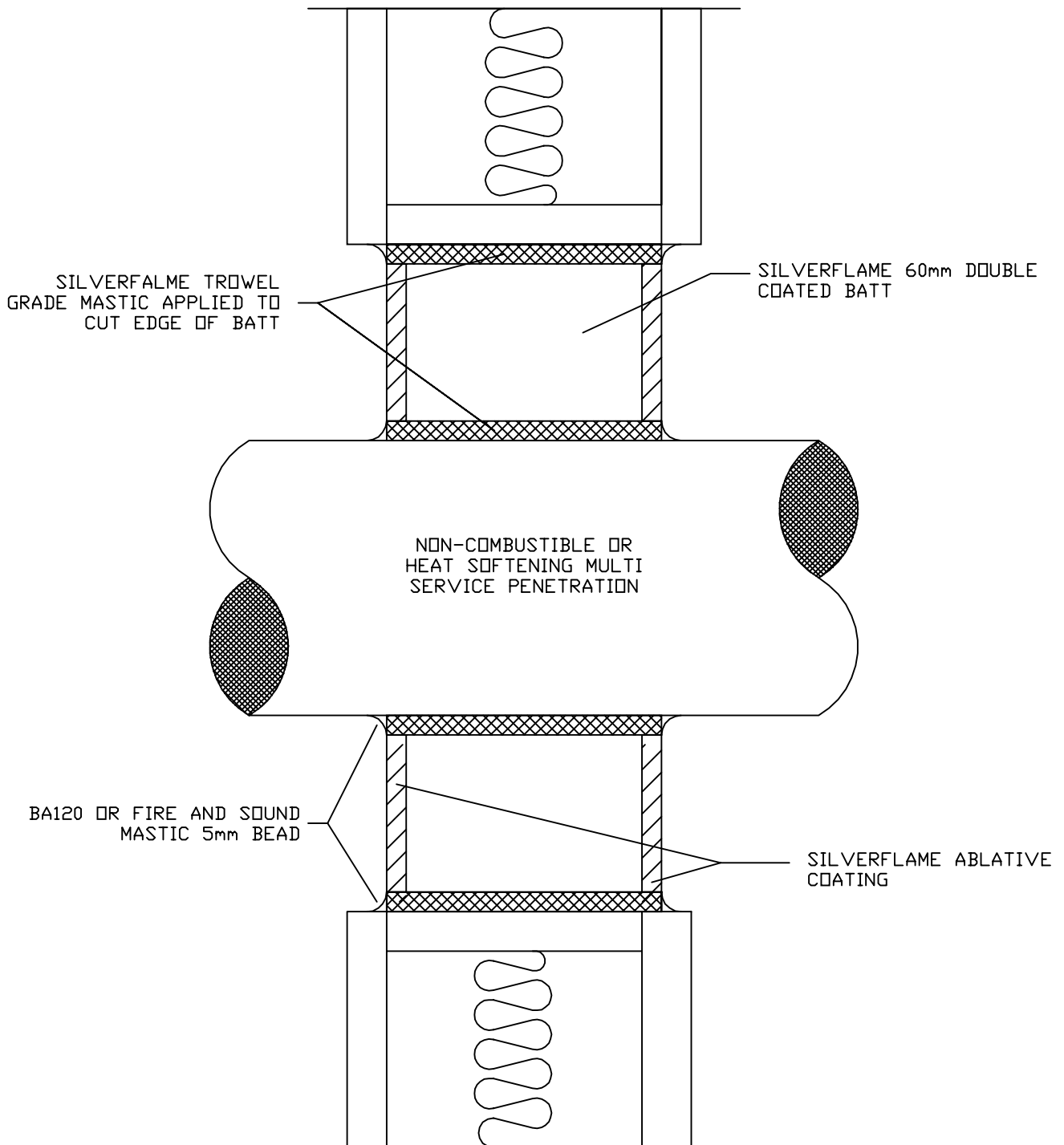

NOTE: IF CLEAR AREA OF OPENING EXCEEDS 0.72m² THE FRAMING WILL BE REQUIRED, REFER TO FIRESTOPIT.COM INSTALLATION MANUAL FOR FURTHER DETAILS.



Firestopit.com
Swadlincote Road
Woodville
Swadlincote
DE11 8DD
TEL: 01283 229022
FAX: 01283 222219

FILE NAME:
DET008

DATE:
30/04/02

THESE DESIGN DETAILS REMAIN THE PROPERTY OF FIRESTOPIT.COM AND SHOULD NOT BE USED IN CONJUNCTION WITH ANY OTHER MANUFACTURERS PRODUCTS OR SPECIFICATIONS. DOING SO MAY RESULT IN THE FAILURE OF THE FIRE STOPPING SYSTEM AND WILL RENDER ANY PRODUCT OR SYSTEM GUARANTEES NULL & VOID